

WORK ZONE MANAGEMENT PROGRAM

Session 6: A Look at the Data

September 11, 2018



U.S. Department
of Transportation

**Federal Highway
Administration**



Polly Okunieff

Technical Specialist, Data
Modeling, ICF

What is a data dictionary?

- A dictionary of terms
- WZ data dictionary contains terms and data concepts that support use cases

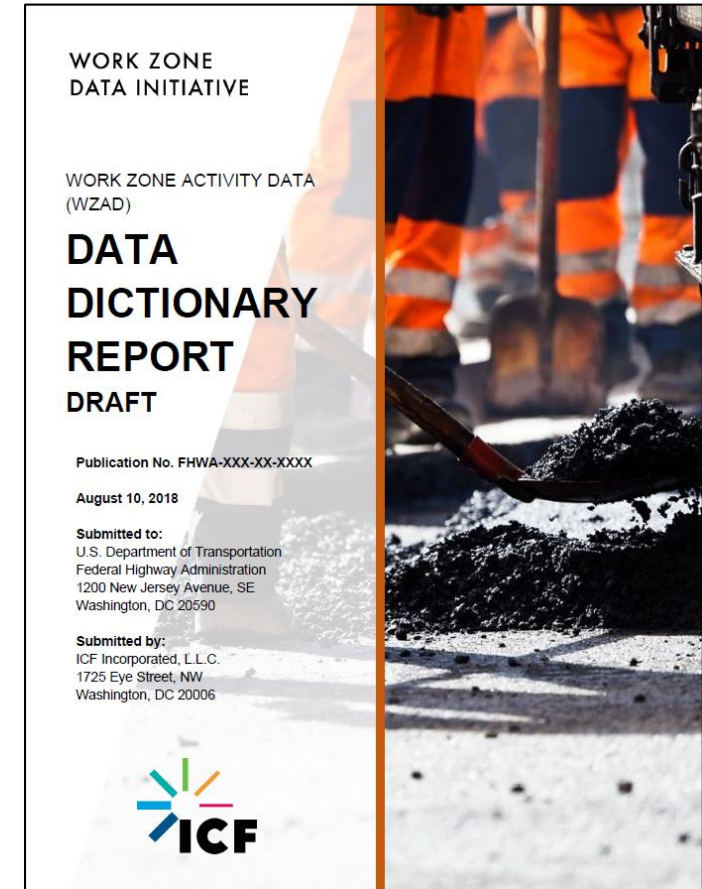

Why do we need a data dictionary?

- Standardize terms for use in the industry to drive a common set of data for harmonization
- Create unambiguous definitions for data
- Minimize data complexity



How was the WZ data dictionary derived?

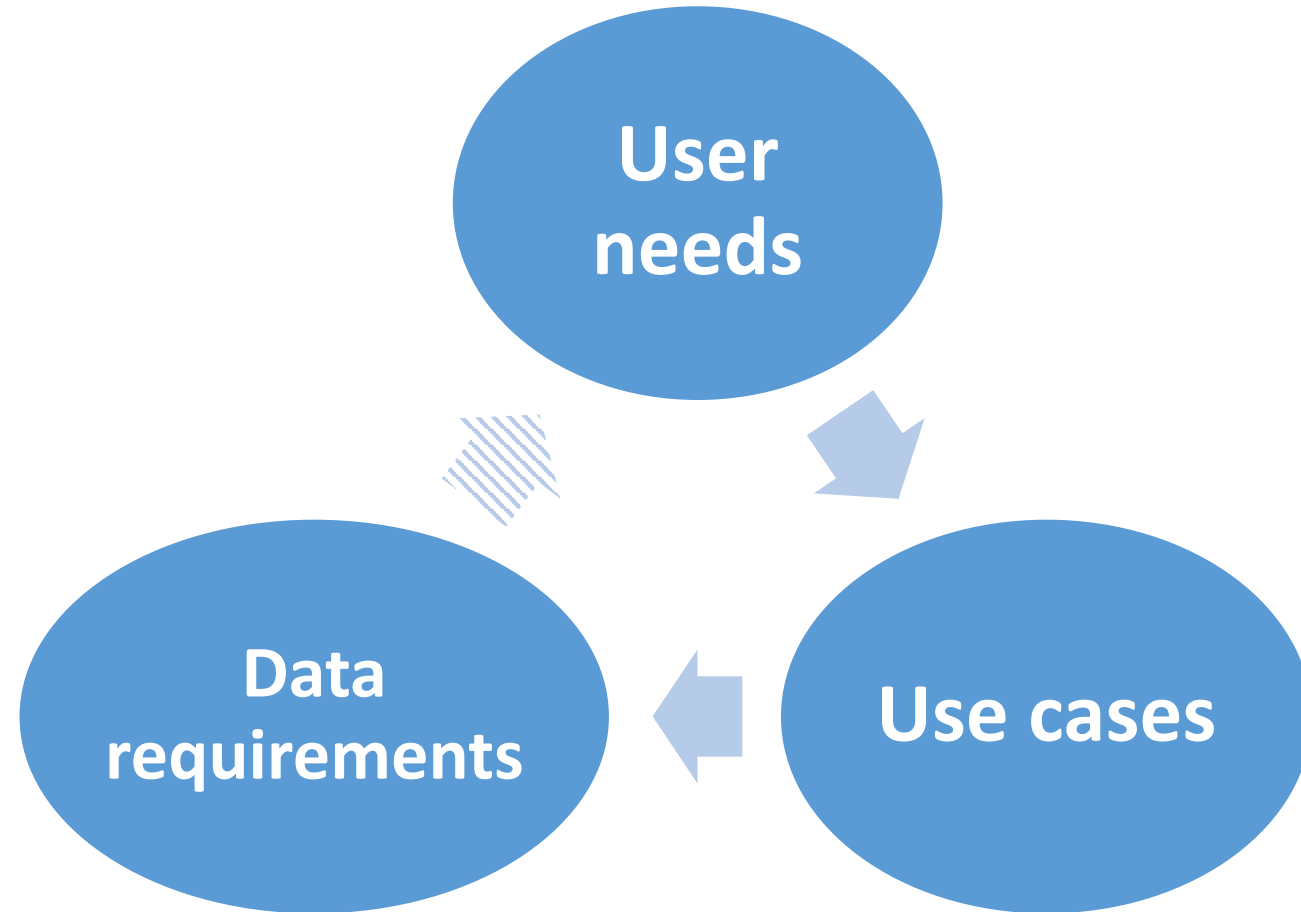

WZ Data Dictionary Content

- **Identification attributes**

- Nomenclature for project, phases, activities, etc.
- Owner agency
- Contractor/subcontractors
- Work type

- **Location attributes**

- Roadway
- Direction of Travel
- Work zone geometry
- Road type

- **Time attributes**

- Start/end dates/times
- Duration
- Recurring time periods

- **Impact attributes**

- Impact to lanes -- (number of lanes closed/open, travel path effect)
- Restrictions by lane
- Planned lane closures

How can the WZ data dictionary be applied to your WZAD?

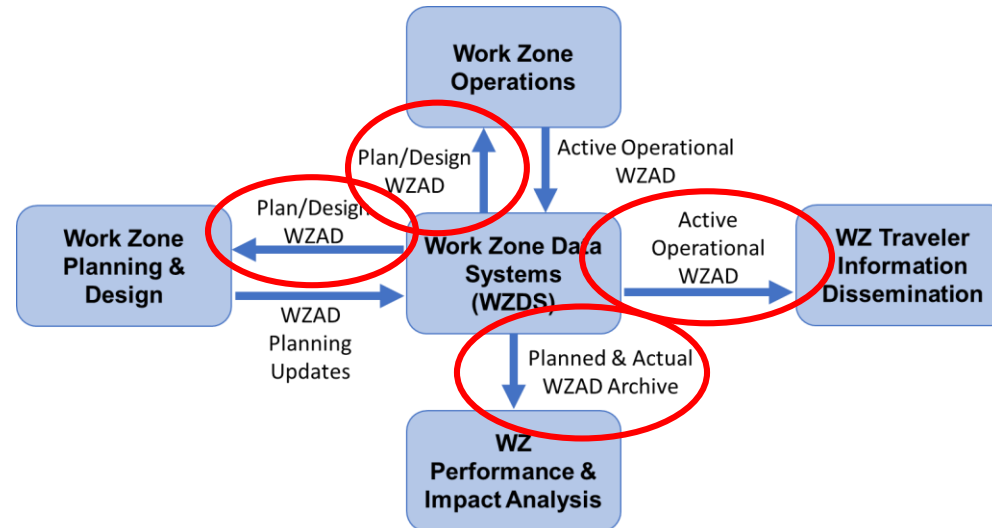
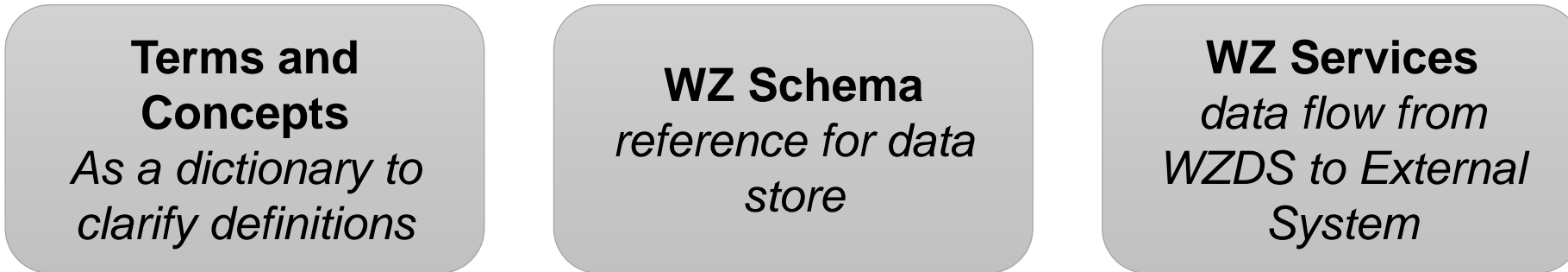

What is in the WZAD dictionary?

Example 1. Construction Project

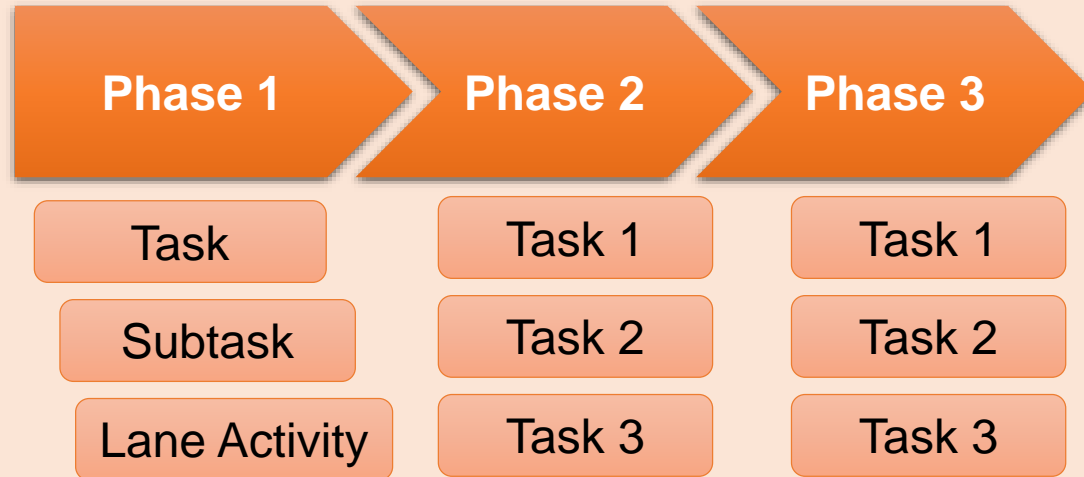

Example 2. Maintenance Project

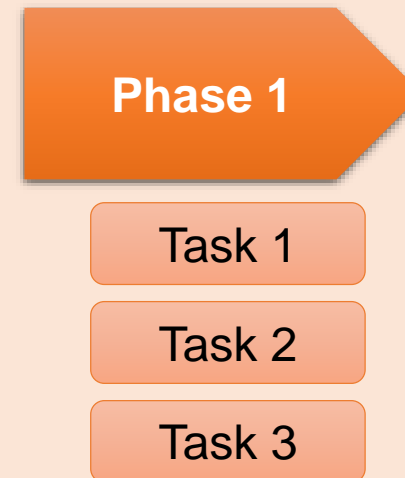

Location Reference Method Example

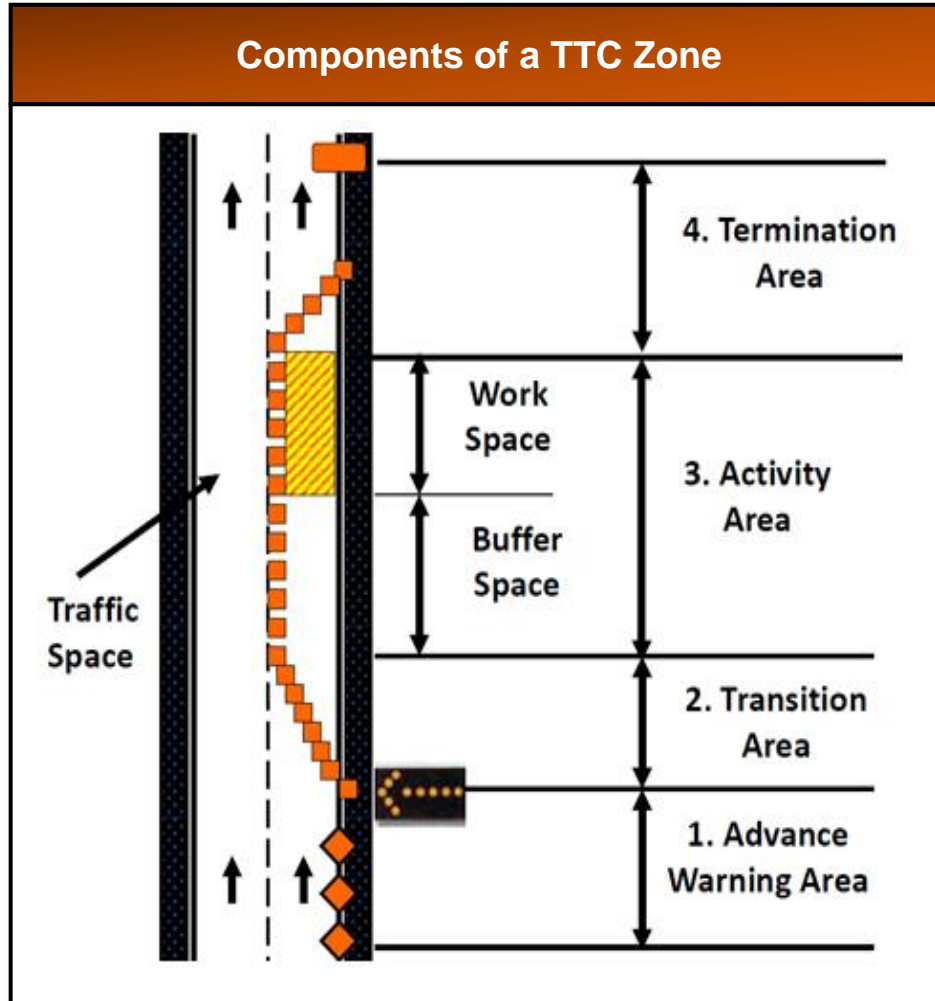

Latitude / Longitude

Linear Referencing System (LRM)

Station / Milemarker

Street / Cross Street

United States National Grid (USNG)

Location Data Requirements

- Enables multiple location referencing methods
- Defines geometry for multiple work zone configurations
- Describes travel path effect

But that is not all...

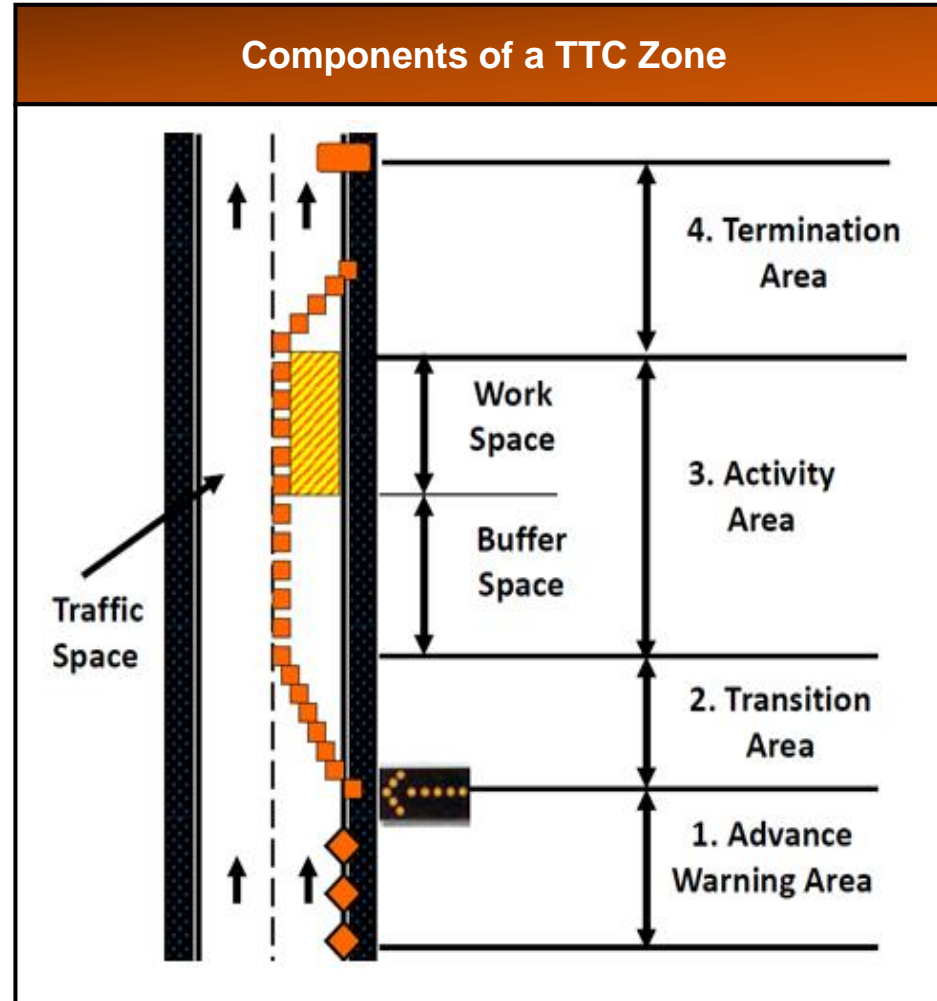

WZAD decomposes work zone geometry

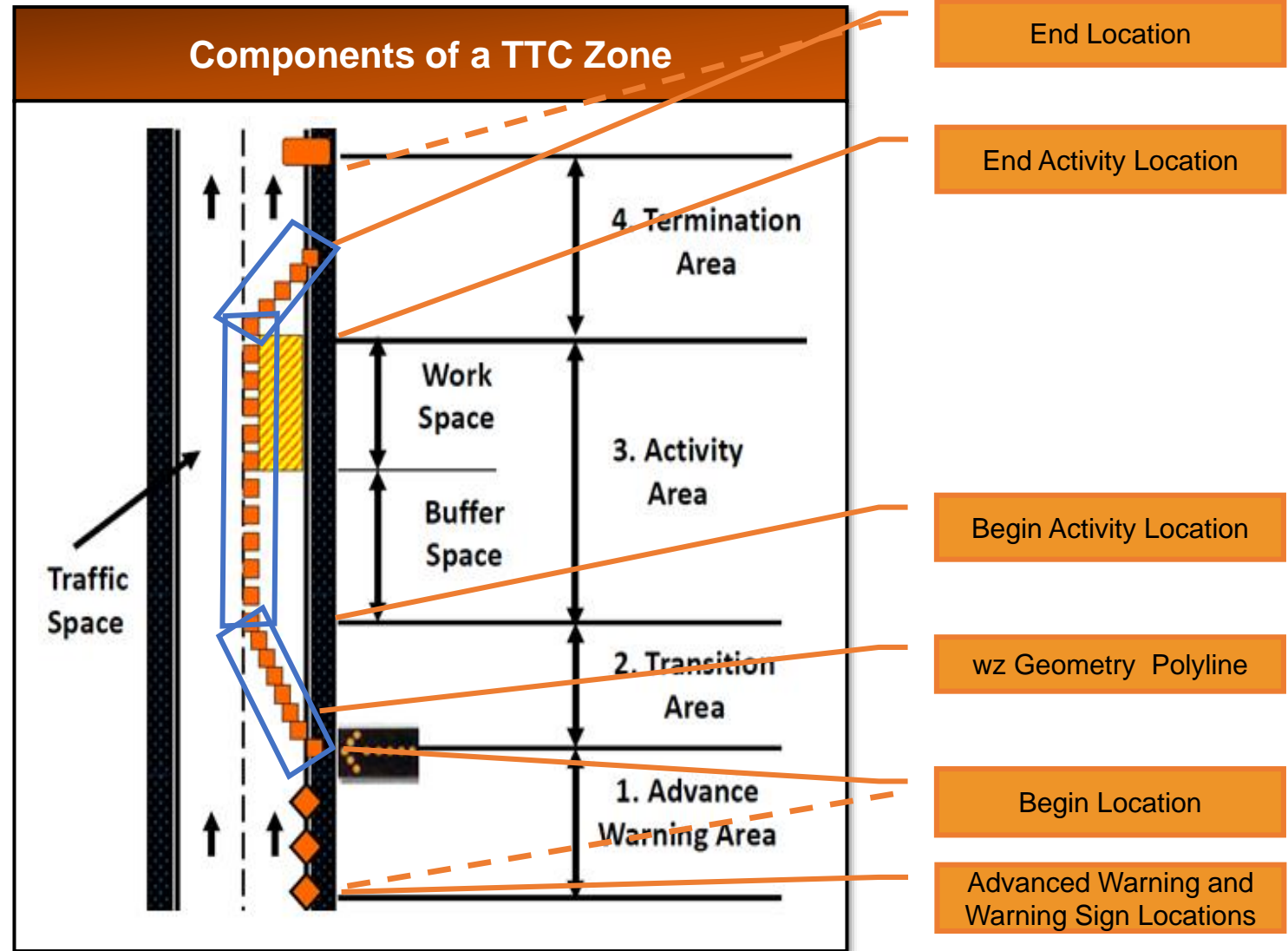

Tell us what WZAD elements are needed?

- **Identification attributes**

- Nomenclature for project, phases, activities, etc.
- Owner agency
- Contractor/subcontractors
- Work type

- **Location attributes**

- Roadway
- Direction of Travel
- Work zone geometry
- Road type

- **Time attributes**

- Start/end dates/times
- Duration
- Recurring time periods

- **Impact attributes**

- Impact to lanes
 - Travel path effect
 - Number of lanes closed/open
 - Total number of lanes
- Restrictions by lane
- Planned lane closures